



INTERNAL LOCATION

This product is suitable for Zone 3 only.
(Not Zone 0, 1, or 2).

Zone 1: the area around the bathtub or shower basin up to a height of 2.25m above the floor and at a radius of 1.2m from the water outlet.

Zone 2: is limited by the vertical planes external to zone 1 and parallel vertical plane(s) 0.60m external to zone 1.

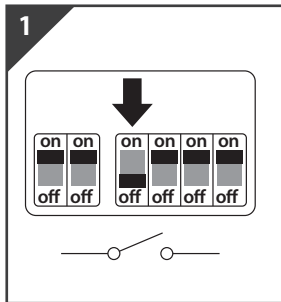

Switch OFF at mains supply before installing

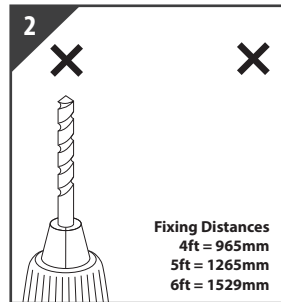

Drill holes to the required distance and install plugs

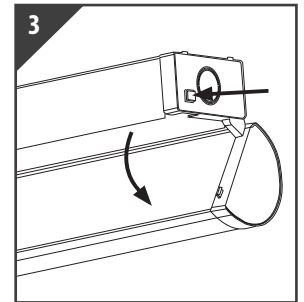

Push button on end-cap and pull open casing

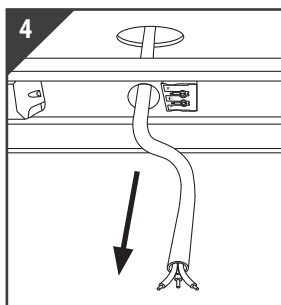

Pull cable from ceiling through hole in batten

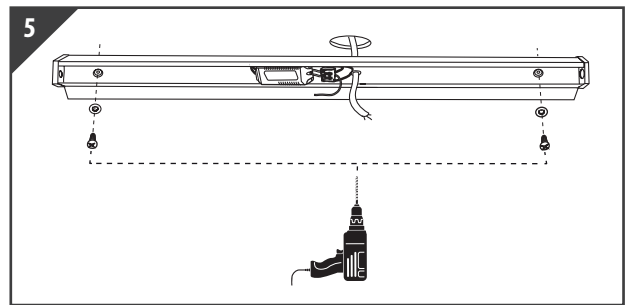

Drill screws into previously installed plugs

Note

Installation must be installed by a qualified electrician (BS7671).

Read before installation and retain for future reference.

Ideal for Indoor use.

Always check for concealed pipes and cables before installation.

Wood or brick mounting surface.

240V-50Hz Incoming supply

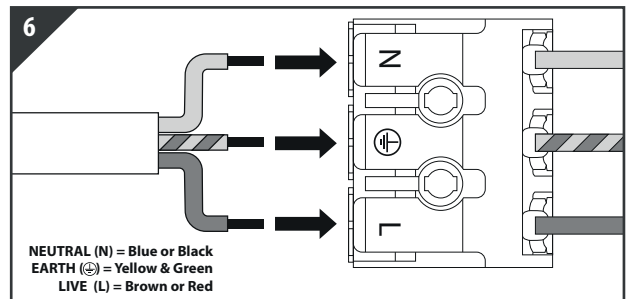

Push down the terminal, insert correct supply (as above) into terminal block and release the push fit terminal to secure.

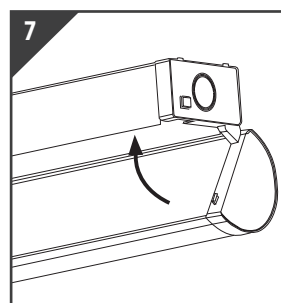

Close casing ensuring it clicks into place

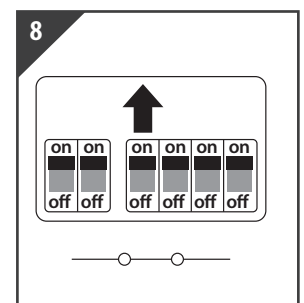

Return power. Switch ON at mains supply

NOTE

DO NOT MODIFY - this will invalidate the warranty and could be dangerous.

Waste electrical products should not be disposed of with household waste.

Please recycle where facilities exist.

Check with your Local Authority or retailer for recycling advice.

This fitting comes with 5 year guarantee as standard. A 1 year on-site warranty is available at no additional cost, however, this must be registered for using the web address shown below. This warranty is subject to our terms & conditions which can be found on the warranty page of our website.

www.supreme.co.uk/warranty



Wiring

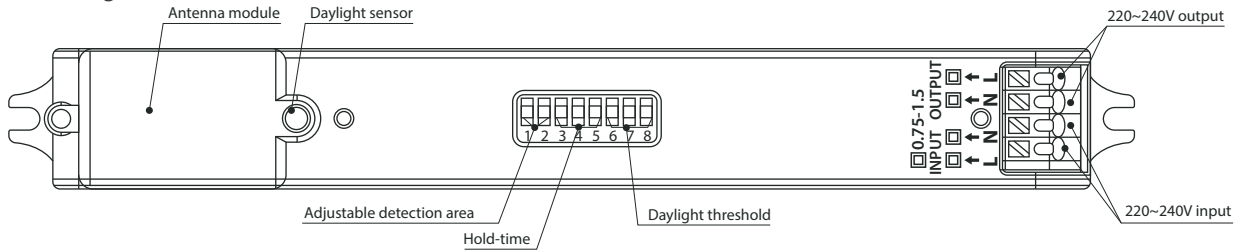

Structure

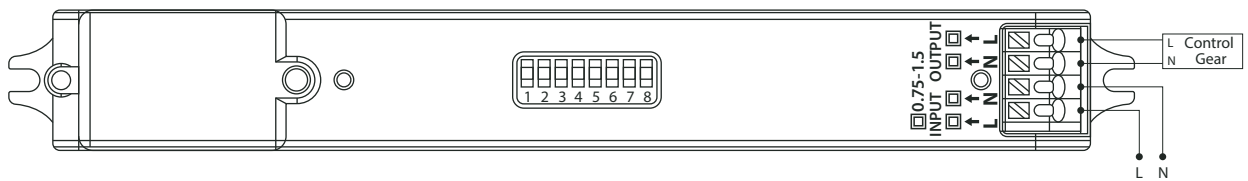

DIP Switch Settings

1&2 - Detection Area (Sensitivity)

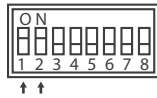

		1	2
I	100%	On	On
II	75%	-	On
III	50%	On	-
IV	25%	-	-

3, 4 & 5 - Hold Time

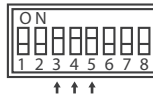

		3	4	5
I	5 Secs	On	On	On
II	30 Secs	-	On	On
III	90 Secs	On	-	On
IV	3 Mins	-	-	On
V	20 Mins	On	On	-
VI	30 Mins	-	-	-

6, 7 & 8 - Daylight Threshold

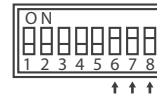

		6	7	8
I	2 Lux	On	On	On
II	10 Lux	On	On	-
III	25 Lux	-	On	-
IV	50 Lux	On	-	-
V	Disable	-	-	-

*Disable means the daylight sensor does not work. The sensor will turn on light once motion is detected regardless of ambient light level.

Factory Setting

Detection Area: 100%, Hold Time: 5secs, Daylight Sensor: Disable

Initialization

After power on, the sensor automatically turns on light at 100% brightness. During the initialization, the sensor is not able to detect movement.

Sensor Function

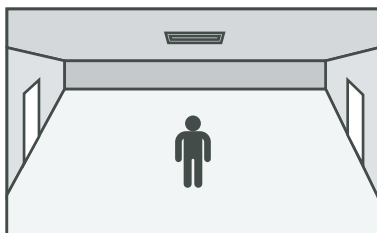

With sufficient ambient light, the light will not switch on even if motion is detected

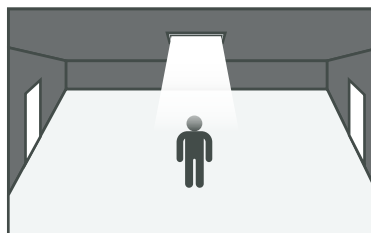

With insufficient ambient light, the sensor switched on the light when motion is detected.



Once the hold time is elapsed, the sensor switches off the light when motion is no longer detected.