

Installation must be installed by a qualified electrician (BS7671).
Read before installation and retain for future reference.
Always check for concealed pipes and cables before installation.

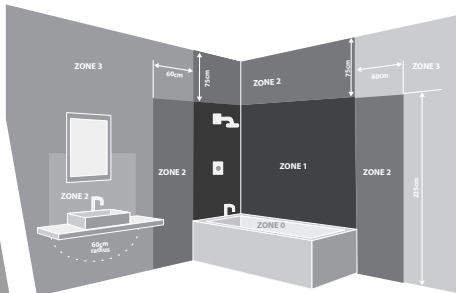

LOCATION

This product is suitable for zones 1 and 2 (not zone 0).

Zone 0: the area inside the bathtub or shower.

Zone 1: the area around the bathtub or shower basin up to a height of 2.25m above the floor and at a radius of 1.2m from the water outlet.

Zone 2: is limited by the vertical planes external to zone 1 and parallel vertical plane(s) 0.60m external to zone 1.

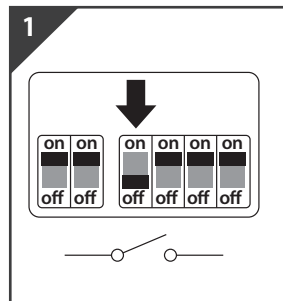

Switch OFF at mains supply before installing

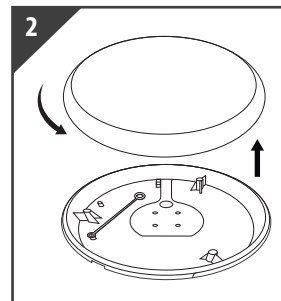

Hold the base securely and twist to unlock and remove the diffuser

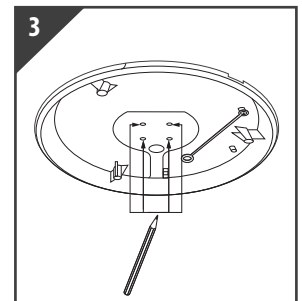

Ensure product is located in the correct location and mark the fixing surface

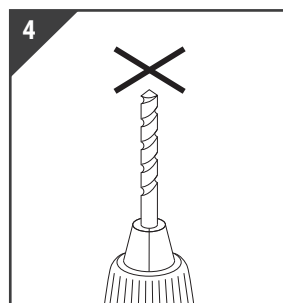

Use correct drill bit to drill screw holes

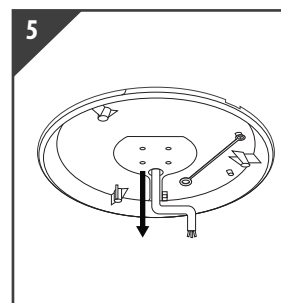

Pull power supply through hole in the base plate

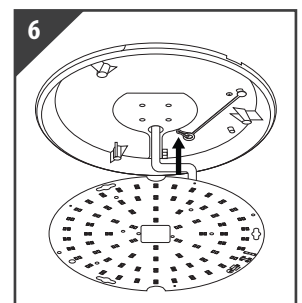

Attach safety belt to gear tray

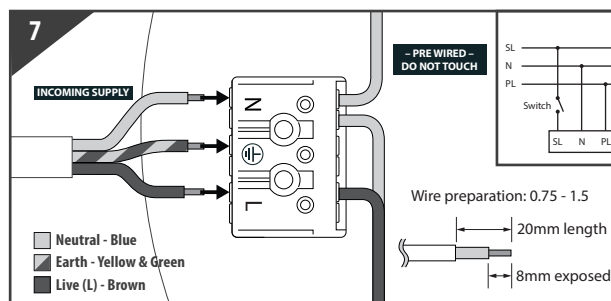

Press the individual terminal and insert the correct incoming supply before releasing the terminal to secure. The product MUST be earthed

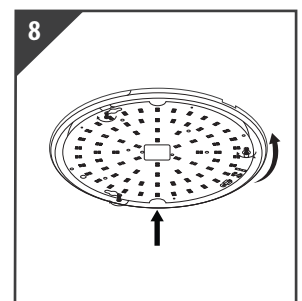

Align gear tray with screws and tighten

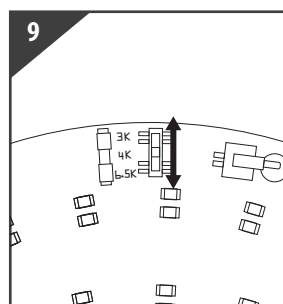

Use the CCT selection switch on the gear tray to select the desired colour temperature

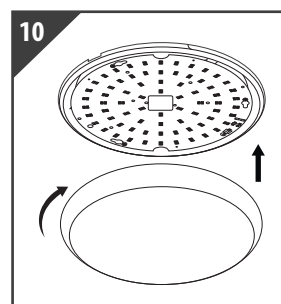

Push and twist the diffuser back into place

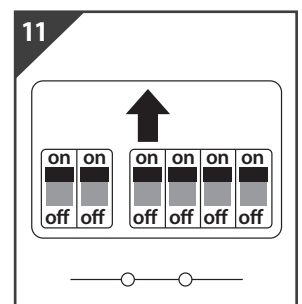

Return power. Switch ON at mains supply



DO NOT MODIFY – this will invalidate the warranty and could be dangerous.

Waste electrical products should not be disposed of with household waste. Please recycle where facilities exist. Check with your Local Authority or retailer for recycling advice.

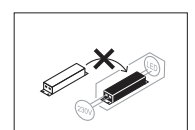
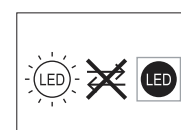

This product contains a light source of energy efficiency class

